



Axis^{AX}

High-performance fire system
for UL Standard compliance





Whatever your fire protection challenge, Advanced brings you unrivalled solutions

Effectively protecting people and property from fire can be complex. Advanced simplifies the challenge without compromising on safety.

Whether you need powerful networking, smoke control and fire audio for large-scale UL projects; extinguishing control and fire system redundancy for critical sites; or fast, fuss-free EN solutions for smaller, wireless installations, Advanced brings you fire safety peace of mind.

Creating a safer future



Advanced – made in the UK. Trusted around the world.

Contact Sasi Kumar, Commercial Manager, to discuss your needs:
skumar@advancedco.com | +44 (0)345 894 7000

Contents

About Advanced	4
Axis AX – The High-Performance UL Fire System	6
Axis AX – Sample System Diagram	10
Integrated Audio and Firefighter Telephones	12
Command Centres	13
Intelligent Detectors	14
Audio Visual, Modules and Pull Stations	15
Gold-Standard Fire System Redundancy	16
Advanced Networking	20
DynamixSmoke – Complete Smoke Control	21
PerfectSync – Fire Audio Perfected	22
Fire and Emergency Telephone System	23
Technical Support	24
Axis AX Parts List	25



Advanced – Made in the UK. Trusted around the world

At Advanced, we're committed to building a safer future. We create fire protection and life safety solutions that protect people and property in more than 80 countries across the globe.

Our products are shaped by decades of research and development expertise as well as ongoing investment in new technologies. This ensures they provide years of high performance and reliability – for ultimate peace of mind.

Everything we deliver is rigorously tested and approved to exacting quality standards – which is why Advanced products are trusted by customers the world over and synonymous with quality, performance and ease of use.



Advanced headquarters, Newcastle, UK

We understand that few fire protection challenges are the same, so as well as our mass-customised ranges, we also offer fully-customised solutions. This flexibility gives you complete control over the functions, format and finish of products to suit your site's unique specification.

We are dedicated to providing excellent service and have an international network of offices and agents to help you access sales support with ease – wherever you are in the world.



In addition, our training and technical services are free of charge to all our direct customers and consistently rated as excellent.

For added reassurance, Advanced is part of the safety sector of FTSE 100 company Halma plc. This global group of life-saving technology companies has a clear purpose to grow a safer, cleaner, healthier future for everyone, every day.

Advanced was named **Fire Safety Systems Manufacturer of the Year** at the Fire & Security Matters Awards 2022.

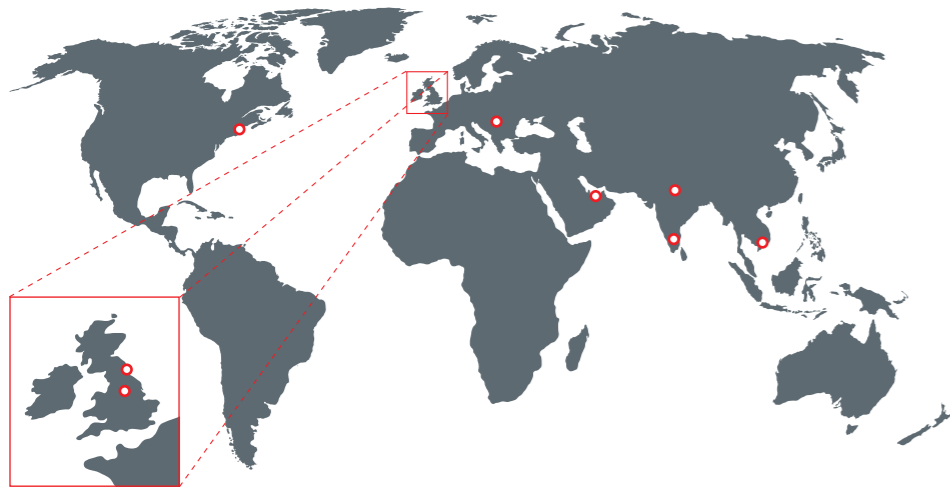

Jebel Ali M-Station, Dubai



Abu Dhabi Airport Fuel Depot, Abu Dhabi

Axis^{AX} protects...



Marassi Al Bahrain Resort, Kingdom of Bahrain



Sands Pointe Miami, Florida

The High-Performance UL Fire System

Axis^{AX}

- is our complete solution for customers demanding a versatile, high-performing fire system that's fully approved to UL 864
- combines addressable panels with audio systems, command centres and a versatile and comprehensive range of wired devices including CO detectors to bring you performance, quality and ease of use
- includes intuitive programming, powerful networking, comprehensive cause and effect and unique diagnostic features that put you in complete control of your fire protection and provide that all-important peace of mind
- can be manufactured with either red or grey fire panels to suit your needs
- is a modular system for easy customisation, offering a wide variety of configurations and applications
- is designed to go anywhere you need high quality, reliable and easy-to-use fire detection and control, from mass transportation and industrial complexes to landmark developments, historic buildings and public services.



Easy to install and use

Axis AX is built on Advanced's outstanding pedigree of fire alarm and detection experience to bring you a range of UL 864-approved fire panels that are simple to install, configure and use.

- Easy-fix removable chassis and in-built software make Axis AX fire panels quick and easy to set up
- Powerful networking, extensive configuration options and comprehensive cause and effect put you in complete control
- Intuitive controls and menus, with simple click-and-select programming for simple and easy commissioning
- The panels support intelligent remote terminals, IP Gateway, I/O drivers and BMS interface for integration with building management systems
- All panels and control centres are manufactured in the UK
- Our highly-rated technical support team can help with advice, tips and training.



Versatility and choice

We know that sites can expand, and fire protection requirements change and evolve over time. That's why we've designed Axis AX to be scalable and flexible, able to adapt as required with minimal fuss or disruption.

- Standalone control panels in one, two and four SLC formats so you can choose the panel size that meets your requirements and budget
- Command centres in modular format for easy customisation, offering a wide variety of configurations and applications
- Remote display terminals available including TouchControl – our 10-inch touchscreen with interactive maps and zone plans for public reception areas
- Each 500mA digital signalling line circuit supports up to 126 intelligent devices
- Up to 200 zones per panel and 25,000 devices per network
- Versatility includes a comprehensive wired and wireless detector range so you can build a system that meets your current and future needs.



Leisure and hospitality

Commercial and retail

Transport and infrastructure

High-rise and residential

Schools and education

Hospitals and healthcare

Manufacturing and technology



Packed with premium features

Every Axis AX panel and command centre comes with a host of advanced features built in as standard, giving you peace of mind that you won't need to buy expensive add-ons in the future.

- Unique diagnostic features include 'scope on board' to provide readings on the panel from any loop, making it easy to identify and investigate any issues
- Comprehensive network diagnostic tool prevents fires and faults from being transmitted across the network
- Built-in multimeter measures all voltages and currents across the system, so you can speed up the commissioning process by identifying voltage/current levels in real time
- Standard peripherals include direct USB and RS232 PC connections, and peripheral expansion is built in for added peace of mind
- Modular in construction, with mass customisation options including the ability to programme your own company logo to appear on the fire panel screen
- 19 built-in LEDs as standard, 5 of which are freely programmable
- Unique auto-test of battery cell integrity
- Easy to synchronise audio and strobes
- Command centres are intuitive and easy for firefighters to operate
- Integrated control of fans and dampers, with unique spreadsheet-style programming matrix
- Built-in false alarm management technology.



Powerful, flexible service reporting

Every Axis AX panel includes an inbuilt easy-to-use, windows-based service tool which saves you time and money by providing easy, instant access to historic and real-time device data, and shows proof of servicing at a glance.

- Demonstrate proof of servicing, download service reports, inspect the device history and keep track of service schedules
- Customisable data filters make it easy to focus on potential trouble spots and ensure they're checked and tested during servicing
- Predict which devices are becoming contaminated so you can clean/replace them before they cause a false alarm
- Customise reports to show the data you need and export it as PDF, Excel or HTML files to prove compliance simply and efficiently.



Axis^{AX}

Axis AX – 1 SLC



- 1 SLC – Class A (Style 6,7) or Class B (Style 4)
- 126 addressable intelligent points
- Available in compact and standard size enclosures
- 2 x 2 Amp Class A (Style Z) or Class B (Style Y) programmable NAC circuits
- 3 x on board relays. 1 trouble, 2 programmable
- System keys for reset, acknowledge, silence, resound and drill
- 3 freely programmable system keys
- 19 on board LED indicators, 5 of which are freely programmable

Axis AX – 2 to 4 SLC



- 2 SLC Panel
 - 2 SLC – Class A (Style 6,7) or Class B (Style 4)
 - 252 intelligent addressable points
- 4 SLC Panel
 - 4 SLC – Class A (Style 6,7) or Class B (Style 4)
 - 504 intelligent addressable points
 - 2 x 2 Amp Class A (Style Z) or Class B (Style Y) programmable NAC circuits as standard, expandable to a total of 4 NAC circuits, 2 Amps each
 - 3 x on board relays. 1 trouble, 2 programmable
 - System keys for reset, acknowledge, silence, resound and drill
 - 3 freely programmable system keys
 - 19 on board LED indicators, 5 of which are freely programmable
 - 5 to 10 Amp system power

Axis AX – Remote Annunciators



- Style 4 or Style 7 network interface
- C version has annunciation and programmable control
- D version annunciation only
- On board USB programming port
- Peer to peer, cross node operation
- Monitored external trouble input
- Info displayed fully configurable to any combination of fires, troubles, supervisory or other alarms
- Both models include programmable status LEDs
- Model ANN-C provides 3 freely programmable function keys
- Optional tamper proof and weather proof enclosures
- Surface or flush mount

Axis AX – with voice evacuation



- Axis AX network node
- Local annunciation, system and audio controls
- Add a local amplifier (optional)
- Ideal for MNS applications
- Remote microphone only option
- User-friendly annunciation and control, identical to FACP
- Installation configurable operations and control
- Ad-Net-Plus Class A or B network compatible
- Supports up to 32 peripheral bus modules
- Multi-channel audio configurations

PENN



Axis AX panels can be customized with a large range of peripheral cards wired directly to the panel, or via the PENN network device, anywhere on the network:

- Integrated and/or networked audio options (see following pages)
- Conventional zone module (8 Class A or 4 Class A) – up to 16 modules per panel
- 4 or 8 way high current relay modules
- Dual NAC Expander
- Style 4 and style 7 network modules
- Fiber optic network converter module
- 48 way I/O switch/LED driver
- Panel mounted printer
- 16 way switch/48 LED module

Axis^{AX} Sample System Diagram

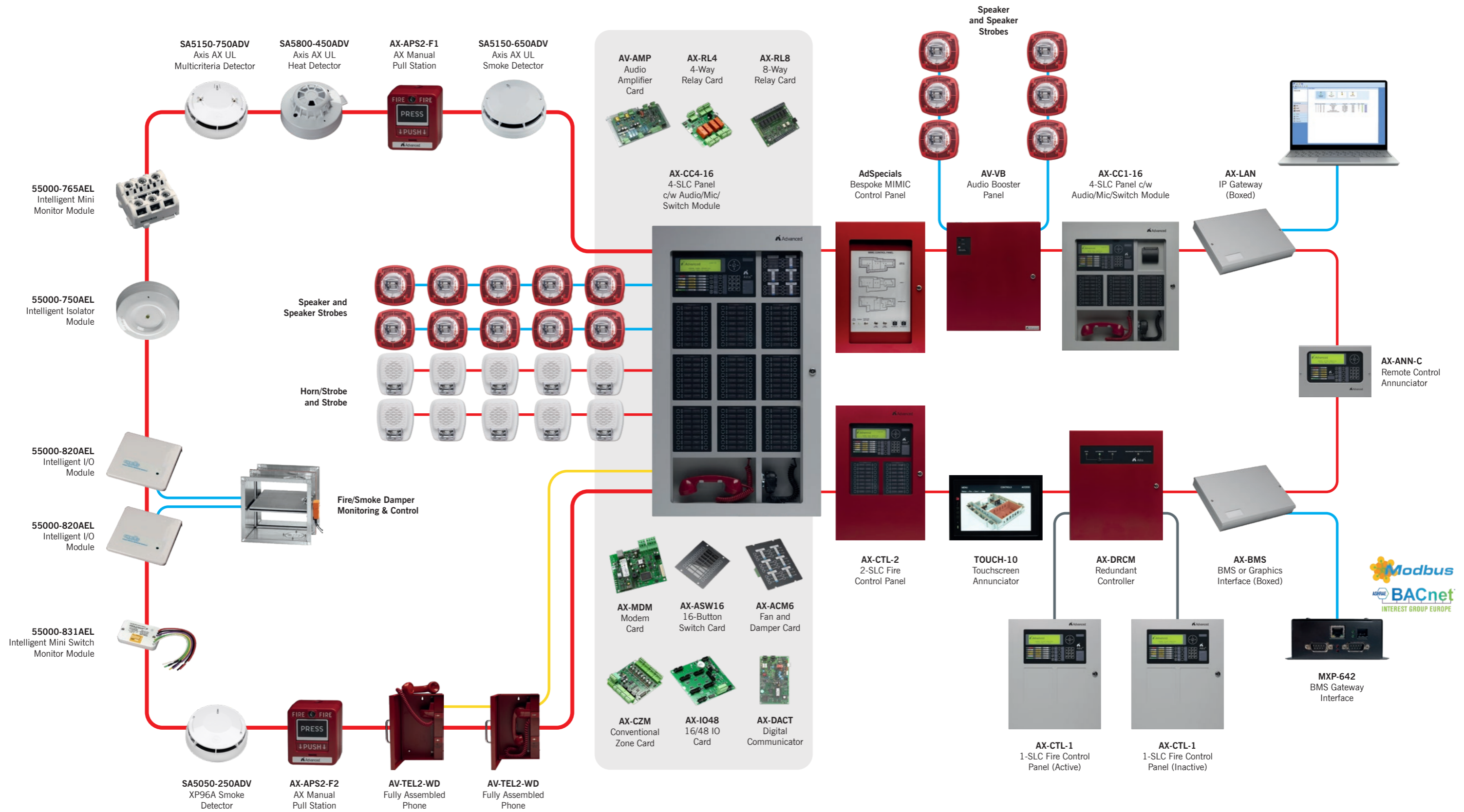

Integrated Audio and Firefighter Telephones

Axis AX comes ready for complete audio configuration. With the addition of an Advanced audio module (AV-AMP-80), any Axis AX control panel or command centre becomes fully audio capable.

A variety of fire fighter telephones and telephone accessories are compatible with all Axis AX command centre panels. Addressable telephones make control, supervision and identification superior to older technological solutions. Command centres come with easy-to-operate LED or LCD telephone switchboard monitoring and control displays.



Audio Booster Panel

- Easy and fast configuration with audio configuration wizard
- Designed to operate as a node on the Axis AX network
- Provides increased digital audio signalling during an emergency situation
- Each amplifier has two independent 40W, 25Vrms outputs
- Each amplifier contains an independent 16 channel digital message/tone generator
- Unique amplifier booster/cascading option
- Superb sound quality
- Simple programming via USB
- Two (2) Class "A" or "B" speaker circuits
- External AC power and trouble LEDs
- Internal service diagnostic and status indicators
- Each amplifier may be programmed for 1 to 1 backup
- Powerful CBE logic programming
- All amplifier audio output signals are synchronised across the AX network



Audio Booster Panel with Microphone

- Fully-featured Axis AX audio panel
- Built-in live voice paging microphone
- Manual message activate switches
- Two (2) Class A or B speaker circuits
- AC power on, amplifier and PSU and trouble LEDs
- Internal service diagnostic and status indicators
- USB interface for message/tone programming
- Optional one-to-one amplifier backup capability
- Three prioritised relay trigger inputs



Fire Fighter/Warden Page Telephone

- Each master supports up to four secondary telephones and/or jacks
- Standard or push-to-talk handset
- Magnetic, keylock or glass break door options
- Standard or coil cord phone cable
- Background noise cancellation module (option)
- Integrated dial, ring, busy and hold tones with connected LED indication

Zone Splitter

- Fits Axis AX command centre or audio panel
- Used with audio module
- 2 input/output options
- 1 input split into 4 outputs (total 40W)
- 2 inputs split in 2x2 outputs (total 80W)



Command Centre Firefighter Phone

- Compatible with Axis AX command centres
- Standard or push-to-talk handset
- Class A or B riser
- Background noise cancellation module (optional)
- Easy installation
- Supports up to 500 field phones

Telephone Riser Module

- Each riser supports up to 250 master phones, (two risers max)
- Live analog audio, no digitisation
- Up to 5 telephones per riser may be active simultaneously
- Easy to configure with DynamixTools telephone wizard
- May be located remotely in separate enclosure or integrated into command centre enclosure
- Supports fire warden remote paging feature
- Class A or B

All-Call Remote Microphone

- Lockable enclosure with microphone
- Completely supervised with interfaced audio amplifier
- Microphone supervised for opens and disconnection
- Advanced CAT30 key access
- Removable inner and outer doors for servicing
- Visible power and trouble LEDs
- PCB service/diagnostic status LEDs
- Plexiglas window
- Surface or semi flush mountable



Addressable Telephone Jack

- Individually addressable telephone jacks
- Phone active LED indicator
- Telephone riser supervision
- Supervises against opens, shorts and grounds
- Class A or B configuration
- Mounts to single gang electrical box
- Field programmable buzzer and LED indicators
- Five phone 'party line' communications
- Slide-in label



Portable Fire Fighter Phone Handset

- Used with any Axis AX addressable telephone jack
- Tip and sleeve connection
- Built-in noise filter
- Standard or push-to-talk
- Background noise cancellation module (optional)

70 Volt Converter Module

- Compatible with Axis AX Audio booster, audio panel, integrated audio panels and command centres
- Converts single or dual 25 Vrms audio output to 70 Vrms audio signal
- All wiring is fully supervised
- Ideal for retrofit applications

Command Centres

Axis AX command centres are built on the backbone of our Axis intelligent fire panels to support a wide variety of configurations and applications.

All command centres are supplied in modular format for easy expansion and customisation. Our smaller command centres can be ordered as fully configured. All of our command centres are fully compatible with Axis AX audio and telephone options. The Advanced telephone riser module can be mounted inside the command centre or remotely within a separate telephone node for added security.

Axis AX Command Centres



- Order fully factory configured or in modular format for configuration on installation
- 1, 2 or 4 SLC
- 126, 252 or 504 addressable points

2 Cabinet Sizes

- 2 cabinet sizes (3' x 3' and 3' x 5')

Network Nodes and Accessories:

- Digital communicator – cellular, ethernet and POTS DACTS
- IP Gateway – only one required for 200 node network
- AX-BMS module – provides interface to building automation system
- Ad-View graphics
- AX-DGP – data gathering panel
- AX-LOCs – local operating consoles
- Smoke control panel
- Graphic annunciator(s)
- AX-VB distributed audio panels
- Telephone node
- Fiber converters

Features

- PerfectSync synchronisation of audio and strobes across entire 200 node network
- DynamixSmoke dedicated/non-dedicated smoke control
- 520Hz audio support
- Failsafe operation if loss of master command centre
- Supports multiple true peer to peer command centre operations
- Intuitive and easy for fire fighters to operate
- Supports request/control/deny command centre operation
- Audio confirmation LEDs indicate when speaker zones are active
- All call, page evacuate, page alert and page inactive and selective paging features
- Manual activation of any message to any zone or group of zones
- No performance degradation as the number of network nodes expands
- DynamixSmoke smoke control
- Mass notification and non fire warning options
- Integrated telephone annunciation (LED or LCD) and controls
- Software wizard provides default telephone and audio options making set-up easy and fast
- Powerful control-by-event programming with intelligent system test facilities provides superior system diagnostic and test functions
- Built-in network, AC power, aux power, battery and field wiring diagnostics
- Colour-coded slide-in labels with large text to identify system functions
- Fire warden page
- PAS, 2-stage, alarm verification and event mode
- Zone and point disable/enable
- 1,000 system zones



PerfectSync

DynamixSmoke

Intelligent Detectors

Axis AX Range

The new Axis AX range of detectors have been specifically developed to meet the demanding requirements of the latest UL standard. Fully compliant with UL 268 7th Edition, they offer swift and accurate fire detection using Purelight® sensing technology and high immunity to false alarms. The integrated smart isolator provides the exact location of any wiring faults and in-built drift compensation monitors the long-term drift of smoke sensors and automatically adjusts to maintain detector sensitivity. The new range is backwardly compatible with existing Discovery protocol installations.



Axis AX UL Smoke Detector

- Approved to UL268 7th edition
- Built-in isolator
- Purelight® optical technology for enhanced smoke detection and false alarm management
- Drift compensation
- Base locking mechanism
- In-built self test
- XPERT card addressing
- Backwards compatible



Axis AX UL Heat Detector

- Approved to UL521
- Electronic temperature sensing
- Alarm flag for fast alarm responding
- Easy installation
- Unaffected by wind or atmospheric pressure
- Ideal for environments that are dirty or smoky under normal circumstances

Advanced XP95A Range

For XP95 protocol users, the latest range of detectors is fully compliant with UL 268 7th Edition.

The detectors are simple to install, easy to use and backwardly compatible with existing XP95A installations. They offer complete peace of mind with fast and accurate fire detection, and a high resistance to false alarms.



Advanced XP95A Smoke Detector

- Approved to UL268 7th edition
- Purelight® optical technology provides enhanced smoke detection and false alarm management
- Internal drift compensation
- Easy installation
- Base-locking mechanism
- Polarity insensitive wiring
- In-built self test
- XPERT card addressing

Compatible Bases



Mounting Bases

The following bases are compatible with both Axis AX and Advanced XP95A detectors.

- Axis AX UL base 4"
- Axis AX UL base 6"



Sounder Bases

This sounder base is compatible with both Axis AX and Advanced XP95A detectors.

- Axis AX high frequency sounder base 6"



Axis AX UL Multi-Criteria Detector (Smoke & Heat)

- Approved to UL268 7th edition
- Built-in isolator
- Purelight® optical technology for enhanced smoke detection and false alarm management
- Drift compensation
- Base locking mechanism
- In-built self test
- XPERT card addressing
- Dual heat sensors

Audio Visual, Modules and Pull Stations

Beacons & Sounders



Beacon

- Available in red, amber or clear
- Lens uses high intensity LED
- Available in outdoor configuration
- 1 Hz flash rate
- Built-in synchronisation
- Integral self-check feature
- Wide angle of visibility
- Beacon flash rate of once per second
- One-way-only detector insertion
- Base to detector locking mechanism

Open Area Sounder/ Beacon

- Steady or temporal signalling
- Available in red or white
- Available in outdoor configuration
- Drastically reduces installation costs
- Programmable volume settings
- Built-in device isolation wiring
- Separate sounder base with drillable knockouts
- Two programmable tones and volume settings
- Continuous 2900 Hz tone
Vols: low 70.6 dB, high 79.1 dB
- ANSI temporal 2900 Hz tone
Vols: low 67.8 dB, high 75.3 dB
- Synchronisation of alert and evacuation tones
- Individual and group addressing
- Unique integral self-test
- Security locking tab

Pull Stations



Manual Single/Dual Action Pull Station

- Single or dual action
- Low profile, high visibility design
- Visual indication of activation including red status LED
- Integrated Form C relay contact
- Surface or semi-flush mountable
- Available in special application colors
- key-lock for reset
- Die-cast metal construction



Dual Action Polycarbonate Pull Station

- Low profile, high visibility design
- Visual indication of activation including red status LED
- Internal access without alarm activation
- Lock reset
- Surface or semi-flush mountable
- Captive screw terminals

Intelligent Modules



Switch Monitor Modules

- Class A (Style D) or Class B (Style B) wiring
- Flexible device type programming
- Optional priority interrupt
- 8 position addressable DIP switch
- Integral status LED
- 4" or 2-gang electrical box mounting
- Following options available:
 - Isolator module
 - Mini switch monitor module
 - Mini priority switch Monitor module
 - Priority switch monitor module
 - Dual priority switch
 - Monitor module



Dual Priority Switch Monitor

- 2x supervised initiating circuits (IDC)
- Dedicated IDC activation status LEDs
- Class A (Style D) or Class B (Style B) wiring
- 4" or 2" electrical box mounting



NAC/Sounder Control Module

- Class A (Style Z) or Class B (Style Y) wiring
- Horn/strobe or speaker control
- Flexible programmability
- 4" square or 2-gang electrical outlet box mounting
- Power limited
- Dedicated NAC status LED
- Voltage-regulated NACs (compatible with all listed NAC devices) – use with regulated 24 VDC power supply
- 25/70 VRMS speaker capability



Input/Output Module

- Supervised initiating device circuit (IDC)
- Class A (Style D) or Class B (Style B) wiring
- Independently controlled Form-C relay contact
- Dynamix I/O relationship programming
- IDC activation status LED
- Optically isolated voltage input
- SLC powered and sub-addressable
- 4" or 2" electrical box mounting



Relay Output Module

- Two isolated Form "C" relay contacts
- Single poll volt-free changeover
- Flexible device type programming
- Powered directly from SLC
- 7-position addressable DIP switch
- Integral status LED
- 4" or 2-gang electrical box mounting
- Durable construction



120V Output Module

- Supervised initiating device
- Class A (Style D) or Class B (Style B) wiring
- Independently controlled 120VAC/30VDC relay contact
- Dynamic I/O relationship programming
- IDC activation status LED

Gold-Standard Fire System Redundancy – Global Applications

Ideal for installations where continuous fire protection is critical, Advanced's redundant control provides total peace of mind by safeguarding people and property and assuring business continuity.

Advanced redundant systems are installed in a range of critical sites around the world including Dubai's largest power and desalination plant, Abu Dhabi airport's aviation fuel depot and telecommunications data centres in South Africa.



Tall Buildings



Refineries/Petrochemical Plants



Power and Utilities Sites



Nuclear Sites



100% Redundancy

Total Peace of Mind

The Advanced redundant fire alarm panel operates in 'hot standby' mode and is ready to automatically take over full control whenever the main panel detects a system trouble/fault.

This means no system downtime and total peace of mind that your fire system will continue to work even when faults occur.

Advanced Fire System Redundancy Means:

- Full panel redundancy – not just a redundant microprocessor
- Simple configuration
- Easy installation and wiring
- Many redundancy options to suit your needs
- No downtime in building safety

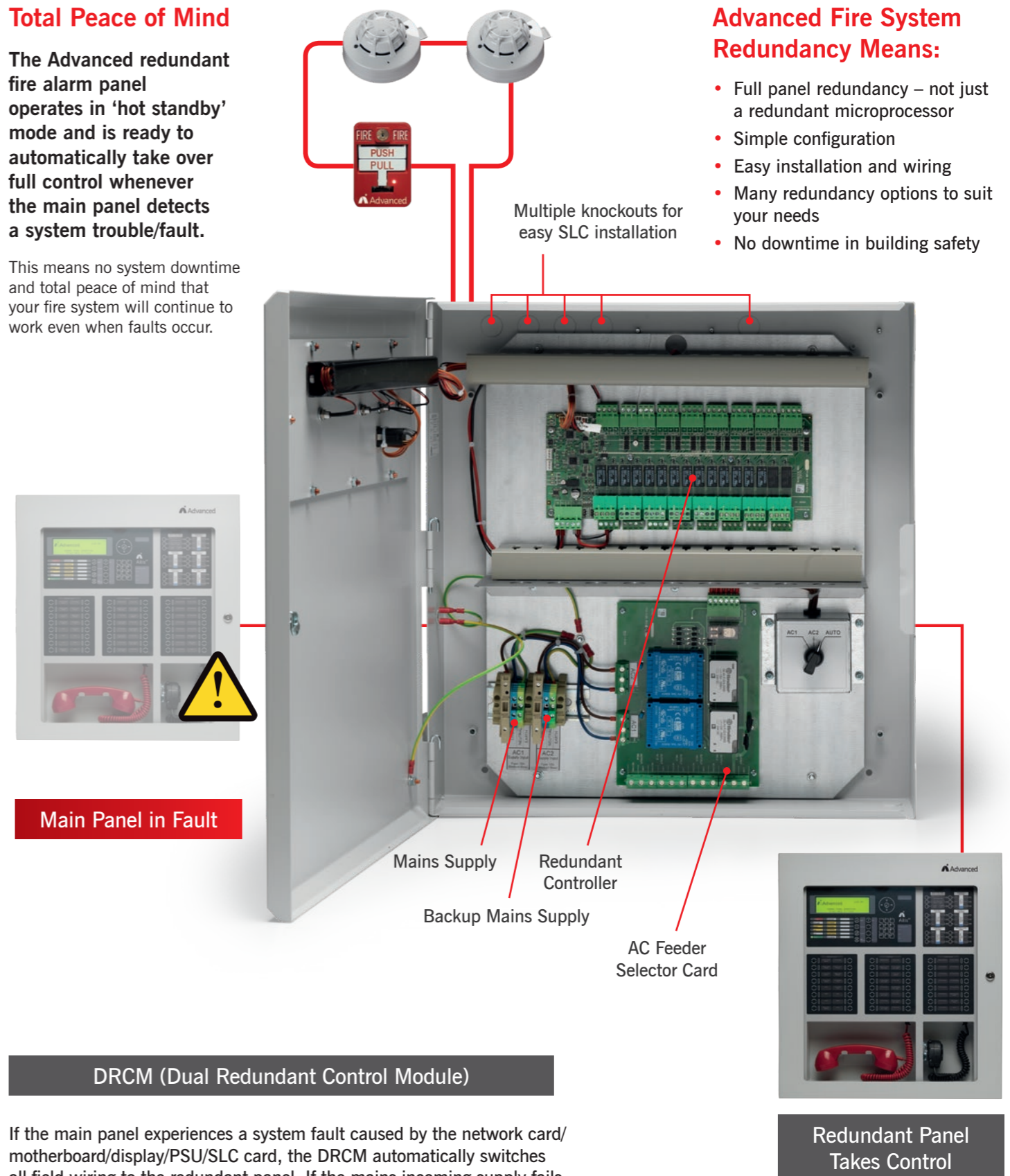

If the main panel experiences a system fault caused by the network card/motherboard/display/PSU/SLC card, the DRCM automatically switches all field wiring to the redundant panel. If the mains incoming supply fails, an internal AC feeder selector card switches to a backup mains supply.

Customised Redundant Control

Fault-Tolerant Networking

Advanced's fault-tolerant networks are wired using two diverse routes. This configuration provides the first line of defense against system failure due to faults.

If a break occurs in the network, data transfer continues in the opposite direction so there is no loss in fire protection.

Redundant Voice Alarm

Where amplifiers are installed within the fire system, they can be configured as 40W amplifiers with backup.

Should an internal trouble/fault on the amplifier occur, the backup amplifier will take control and maintain the integrity of the system.

Amplifier with in-built redundant backup within command centre/panel

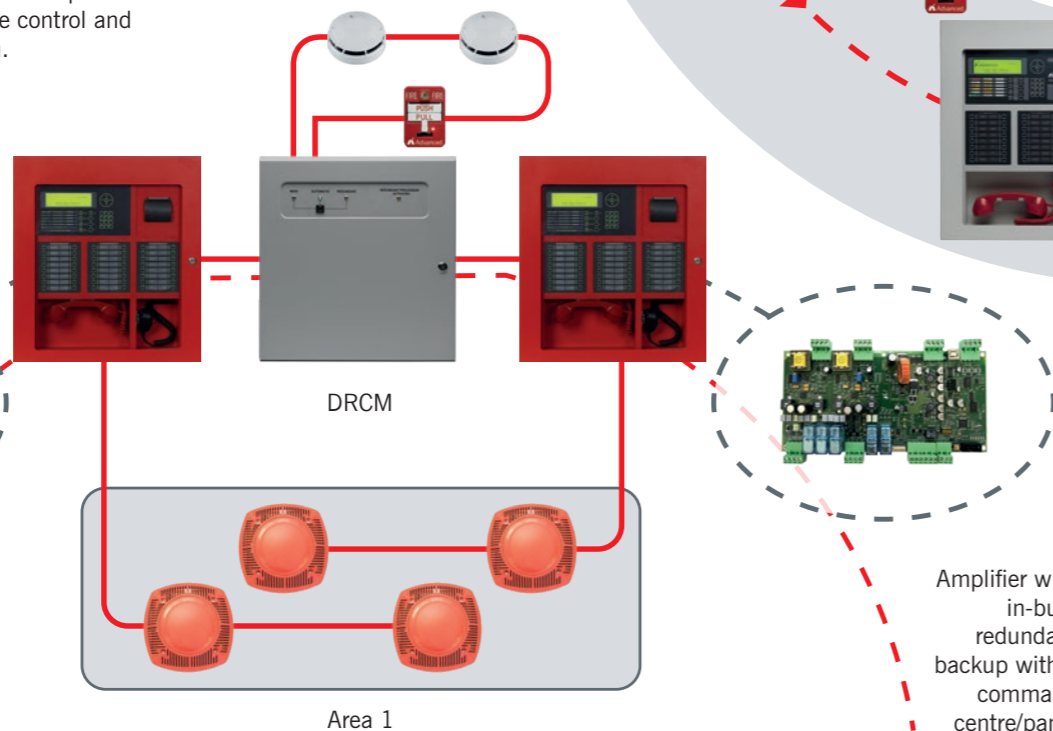

Amplifier with in-built redundant backup within command centre/panel

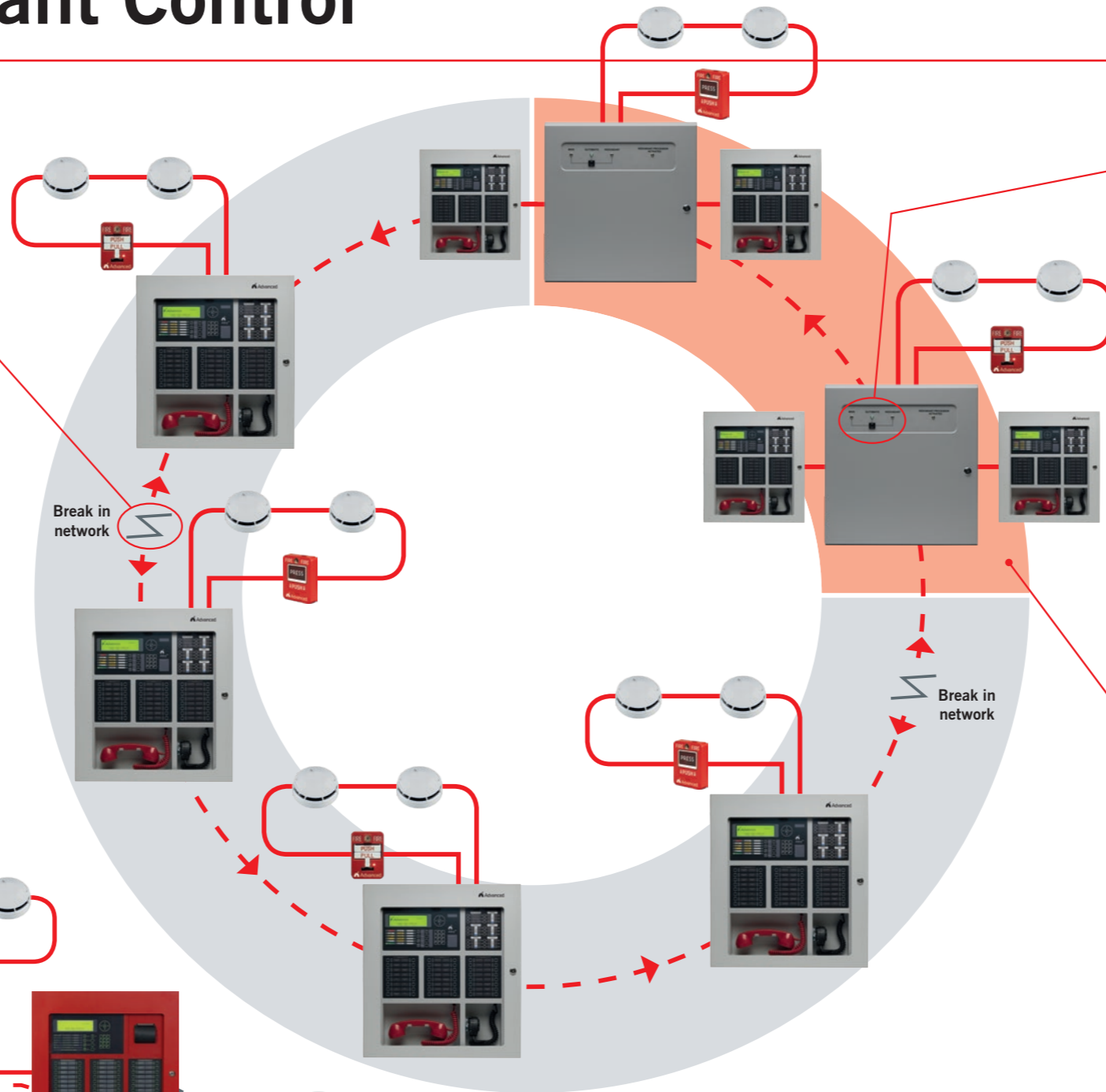

Control Options

You choose the level of control you want to have over your redundant system.

We design fully automatic redundancy as well as providing options for manual control.

- Main, automatic or redundant control options
- LED or customised indication
- Key switch control for maintenance purposes

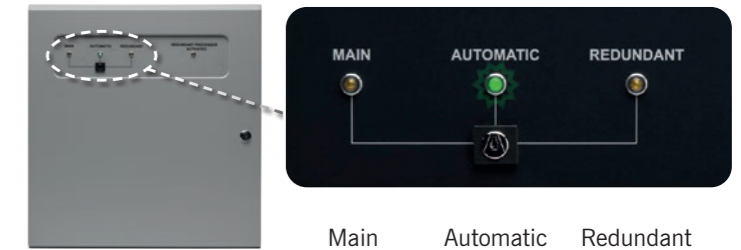

Critical area of the system requiring redundant control

Depending on the nature of your site, you may not require full redundant control across your entire system.

We give you the option to install and configure redundancy exactly where you need it, saving you time as well as material and installation costs.

Simplicity

Our AdSpecials custom-build department creates redundant panels to meet your needs, following a clear and simple process.

Configuration is easy, with only one file required for the whole network.



Data from up to 200 panels stored in one configuration file

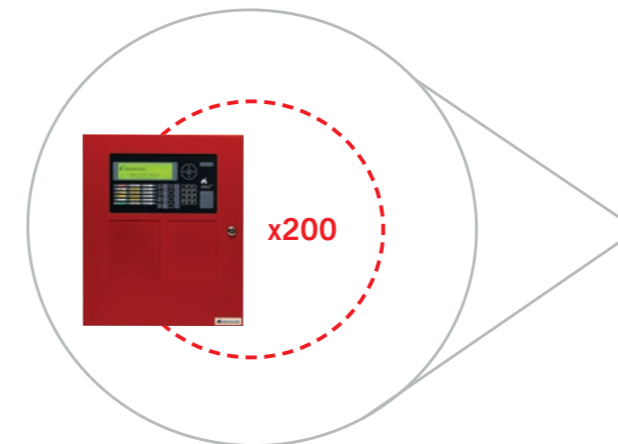

Advanced Networking

Advanced delivers fast, reliable, peer-to-peer communications from the smallest two panel network up to a large 200 node network.

Advanced network systems are fully scalable to suit virtually any application including 'campus' style and 'high rise' style configurations. Built-in diagnostics and test facilities make installation and ongoing maintenance simple. Performance exceeds multiple international standards.

- Peer-to-peer performance for optimum distributed intelligence
- Consistent system performance independent of the number of nodes
- Synchronisation of audio and strobes across entire 200 node network
- Fail Safe operation if loss of master command centre
- Supports multiple true peer-to-peer command centre operations
- Request/control/deny
- Sectoring feature allows customised operations per node
- Integrated or Isolated high rise telephone network option
- Single or multiple DACT, radio and/or city tie options
- Offline test option isolates panels from network during testing without fear of false alarms
- Class B cable wiring – 32 nodes, 5,000ft maximum
- Class A cable wiring – 200 nodes, 5,000ft between nodes, 66,000ft maximum
- Fibre cable – 16,404ft max between nodes
- ipGateway transmits emails and text messages via a secure internet connection while also allowing remote viewing of system status and controls
- AdView graphics provides graphical user interface in single or multiple stations
- AX-BMS interfaces to third party building automation and controls solutions via standard BACnet or Modbus communications
- One configuration tool is required to program Axis AX panels. Diagnostic features prevent erroneous actions that may be detected prior to on-site installation and test
- Each intelligent audio node contains up to 16 digital messages which are synchronised across the entire 200-node network
- SLC power technology built into each panel provides tremendous application options
- Nodes may be customised to suit any application, reducing installation costs and maximizing performance. Nodes may (or may not) include SLC, displays, microphones, telephones, amplifiers, power supplies, switch modules, and any AX peripheral device.

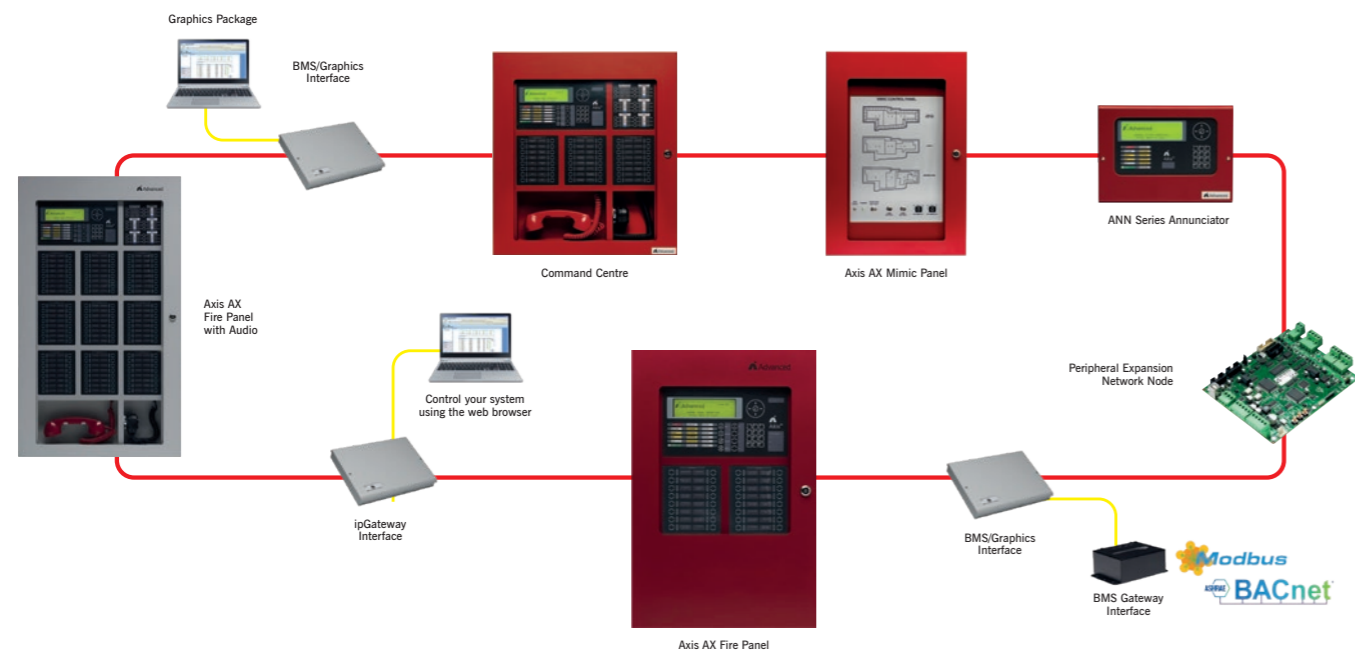

Type of network	Style 4	Style 7
Typical use	Sites where one panel per building controls evacuation	Sites where more than one panel per building controls evacuation
Setup	Standard network card	Fault-tolerant network card
Maximum cable length	Up to 1.5 km	Up to 1.5 km between nodes
No. of nodes	32 (50 with booster)	200
No. of zones	Up to 1,000	Up to 1,000
Typical time to communicate first event	1 second	3.5 seconds

DynamixSmoke

Complete Smoke Control

Approved to:
UL864 standards – complies
with UUKL requirements.

Integrated Fan and Damper Control

Advanced's Axis AX fire system features DynamixSmoke, dedicated and non-dedicated fan and damper control, for fire and life safety. As you'd expect from Advanced it's a high performance solution that is easy to configure and maintain, even on the most complicated sites.

Features

- Regulatory compliance assured
- Automatic and manual smoke control options in accordance with NFPA and National Building Code Standards
- Dedicated smoke control auto/manual controls and LED status indicators
- Customised FSCS firefighter smoke control (graphic) stations can be located locally or remotely
- Groundbreaking ease of use
- Simple spreadsheet-style programming matrix is a step change that makes even the most complex smoke control programming easy
- System divided into virtual smoke control compartments in software for automatic fan and damper control (cbe)
- Uses standard I/O modules for fan and damper interfacing. Software auto-configures outputs for run/stop and open/close, with feedback inputs if required
- All options configurable from one dedicated menu with the Config Tool
- Interlocking feature to prevent over pressurisation of ducts
- Post-fire purge options with configurable priorities
- Auto stairwell pressurisation option
- Key switch enable/disable option
- Manual controls can be configured for one-to-one operation, or grouped one-to-multiple fans or dampers
- Duct probe option – will override auto settings if smoke detected
- The system can respond only to the first smoke compartment in alarm or priorities can be set so that devices respond dynamically to a spreading fire
- Dedicated smoke control reset function
- All manual controls take priority over automatic mode
- Adjustable feedback delay ensures fans are given time to run or a damper is allowed time to travel before any trouble conditions reported
- Fully programmable sequential fan restart to avoid power spikes
- Automatic testing of fans and dampers including scheduled 'holiday' dates
- Engineering test menu allows HVAC to be controlled using panel menu and provides current operation and status feedback
- Customisable intelligent graphic annunciators with simple connection and configuration via panel P-BUS/PENN.



Simple Smoke Control Programming Matrix

Watch the DynamixSmoke video on YouTube: [Advanced Fire](#)



PerfectSync delivers best-in-class synchronisation of audio and strobes for fire, life safety and mass notification applications. PerfectSync achieves a level of integrity and performance not seen before.

Features

- Synchronisation of audio and strobes across entire Axis AX network
- Dynamically adjusts as conditions change
- Prevents confusion during an emergency
- Aids in meeting intelligibility requirements
- No need for special programming or wiring
- Axis AX network capacity
 - 200 panels
 - 3200 distributed amplifiers
 - Each amplifier contains its own digital message generator
 - Each message generator can support 16 messages
 - 800 built-in NAC circuits
- Total synchronisation

All speakers turn on and are fully synchronised even if the same message is played from different amplifiers connected to different panels on a large network. The maximum time to re-activate any speaker output following the first message played does not exceed 5 seconds.

When a fire spreads, any new affected areas or higher priority messages will begin immediately. This may result in some areas

of the building being briefly out of sync. With PerfectSync these areas will quickly re-synchronise again even on a large network system. Similarly paging operation may result in some areas of the building being temporarily out of sync as any automatic message must recommence from the beginning. With PerfectSync these areas will quickly re-synchronise.

- More audio flexibility

Up to 16 digital pre-recorded messages per amplifier. Simple 3-channel audio (evacuate, alert, page) to complex multi-channel mass notification including individual message prioritisation.

Unique audio engineering test feature confirms which amps are active, what message is playing, and can select and play a message in a specific area.

Command centre audio control lockout with indication of who's in control.

Fire and Emergency Telephone System
 Exceptional Clarity for Superior Performance



Providing robust telephone communication channels ensures maximum safety.

The Advanced fire and emergency telephone system provides:

- **Addressability** – for precise identification of the location of field telephone users.
- **Flexibility** – so it can be configured as a standalone, independent system or completely integrated into the fire system.
- Crystal-clear live voice channels with no delays or echoing and a background noise cancellation option.
- Reassurance of communication channel status via dial, ring, busy and hold tones, as well as local LED indication at each addressable handset.

Quick and easy to install and configure.

Ideal for installations where local fire departments and emergency/facility personnel need access to fire/emergency telephone communications, e.g. in high and low-rise apartment buildings, hotels, universities, government and military sites.

As an entire telephone system can be installed and configured to operate standalone without panels, Advanced fire and emergency phones are also perfectly suited to any retrofit or non-fire application.

Visit www.advancedco.com to download our Fire and Emergency Telephone System brochure

Axis^{AX} Parts List

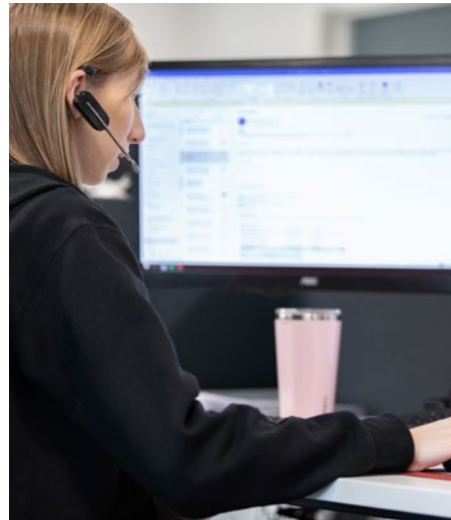

Technical Support

Advanced³⁶⁰*

Highly rated customer support. Available by telephone and online.

When you set up an Advanced360 account, you gain access to a host of helpful advice and support.

An account also gives you access to a wealth of online information, from 'how to' videos to datasheets and detailed product manuals. And everyone with an Advanced360 account can benefit from our dedicated monthly newsletter, packed with useful hints and tips.

Services include:

- **Technical support** – available by phone and online from one of our experienced technical support engineers
- **Support history** – open and view your live support tickets and see your full support history – enabling you to refer back to previous advice where required



- **Training** – view and book training slots (direct customers only), and download your training certificates at any time
- **Software** – download software and save your software packages by installation/site
- **Literature** – download manuals, specifications, approved partner certificates, technical information and more
- **Warranty certificates** – download warranty certificates for your sites.



Sign up now at advancedco.com

Product Code	Description
Control Panels <i>(Also available in grey. Add -G to product code)</i>	
AX-CTL-1C	1-SLC Fire Alarm Control Panel – Red
AX-CTL-1	1-SLC Fire Alarm Control Panel – Red
AX-CTL-1L	1-SLC Fire Alarm Control Panel – 2' x 2' Fault Free – Red
AX-CTL-2	2-SLC Fire Alarm Control Panel – 2' x 2' Fault Free – Red
AX-CTL-4	4-SLC Fire Alarm Control Panel – Red

Control Panels with Audio/Micro <i>(Also available in grey. Add -G to product code)</i>	
AX-CTL-1V	1-SLC Fire Alarm Control Panel – 2' x 3' with Voice – Red
AX-CTL-2V	2-SLC Fire Alarm Control Panel – 2' x 3' with Voice – Red
AX-CTL-4V	4-SLC Fire Alarm Control Panel – 2' x 3' with Voice – Red

Control Panels with Audio/Micro/Switch Module <i>(Also available in grey. Add -G to product code)</i>	
AX-CC1-16	1-SLC Command Centre FACP – 3' x 3' Red Eng with Voice
AX-CC2-16	2-SLC Command Centre FACP – 3' x 3' Red Eng with Voice
AX-CC4-16	4-SLC Command Centre FACP – 3' x 3' Red Eng with Voice

Touch 10 Remote Terminals <i>(No UL-listing)</i>	
AX-TOUCH-10	Touchscreen Terminal (Standard Network)
AX-TOUCH-10/FT	Touchscreen Terminal (Fault Tolerant Network)
AX-TOUCH-10-SBB	Touchscreen Surface Back-Box

Local Operating Consoles <i>(Also available in grey. Add -G to product code)</i>	
AX-LOC1/ST4	Local Operator Console 1 – 2' x 2' Deep – Standard Network
AX-LOC1/ST7	Local Operator Console 1 – 2' x 2' Deep – Fault Tolerant Network
AX-LOC2/ST4	Local Operator Console 2 – 2' x 2' Deep – Standard Network
AX-LOC2/ST7	Local Operator Console 2 – 2' x 2' Deep – Standard Network
AX-LOC3/ST4	Local Operator Console 3 – 2' x 3' Deep – Standard Network
AX-LOC3/ST7	Local Operator Console 3 – 2' x 3' Deep – Standard Network
AX-LOC4/ST4	Local Operator Console 4 – 2' x 3' Shallow – Standard Network
AX-LOC4/ST7	Local Operator Console 4 – 2' x 3' Shallow – Standard Network

Remote Terminals <i>(Also available in grey. Add -G to product code)</i>	
AX-ANN-C	Remote Control Annunciator
AX-ANN-C/ST7	Remote Control Annunciator – Style 7
AX-ANN-D	Remote Display Annunciator
AX-ANN-D/ST7	Remote Display Annunciator – Style 7

LED Annunciators	
AX-LED16RY	Addressable 32-LED Red/Yellow Module
AX-LED32R	Addressable 32-LED Red Module
AX-LED32Y	Addressable 32-LED Yellow Module

Network Cards <i>(Also available in grey. Add -G to product code)</i>	
AX-NET4	Plug-In Network Card – Style 4
AX-NET7	Plug-In Network Card – Style 7
AX-DCI	AX DCI 24V:24V DC:DC Isolated Supply

Product Code	Description
Expansion Modules	
AX-NAC	Plug-In 2 x NAC Extender US Product
AX-LPD	Plug-In 2 x SLC 2 x NAC Extender US Product
AX-SEB	AX-DACT Interface Kit
AX-DACT-D9068P	Digital Alarm Communicator PCB, FACP Powered
AX-DACT-PRG	LCD Keypad for Programming D9068DACT
AX-DACT-CP	Carrier Plate for AX-DACT for AX-CTL1 Panel
AX-DACT-CP2	Mounting Plate for AX-CTL2/4 and AX-CC Panels
AX-CZM	Conventional Zone Monitor – 4 x Class A or 8 x Class B Conventional Zones, 3 Relay Outputs
AX-ASW16	16-Way Addressable Switch/LED Module
AX-IO48	16 Inputs and 48 Outputs Module
AV-AMP80	AV Amplifier Assembly (Panel)
AX-PSU	Power Supply Module
AX-PSU-6	Power Supply Module for AX-CTL Panel Range
AV-V70*	70V Audio Converter and Cabinet
AV-V70-KIT*	70V Audio Converter PCB and XFMR
AV-ZS*	Audio Zone Splitter. Splits 1 x 40W into 4 or 2 x 40W into 2 each
AV-ZS-CM*	Splitter Switch Module. Mounts to inner door of AV-VBM
AX-PENN/ST4	Peripheral Exp Net Node (Standard Network)
AX-PENN/ST7	Peripheral Exp Net Node (Fault Tolerant Network)
AX-RL4	4-Way Relay Output Card (Programmable)
AX-RL8	8-Way Relay Output Card (Programmable)
AX-RL10	10-Way Relay Output Card (Programmable)
AX-DCF	AX-DCF 24V DC Filter

*Also available in grey. Add -G to product code.

Network Interfaces	
AX-BMS*	Graphics Interface – Standard Network (Boxed)
AX-BMS/ST7*	Graphics Interface – Fault Tolerant network (Boxed)
AX-BMS-PCB	Graphics Interface – Standard Network – Card and Spares Kit
AX-BMS-PCB/ST7	Graphics Interface – Fault Tolerant Network – Card and Spares Kit
AX-LAN*	IP Gateway – Standard Network (Boxed)
AX-LAN/ST7*	IP Gateway – Fault Tolerant Network (Boxed)
AX-LAN-CAB*	IP Gateway – Enclosure
AX-LAN-PCB	IP Gateway – Card and Spares Kit
AX-LAN-PCB/ST7	IP Gateway – ST7 Card and Spares Kit

*Also available in grey. Add -G to product code.

Software and Leads	
AXPC-NET-003	AX Config Tool Software and Lead
AXPC-NET-018	AV-AMP Config Tool Software
UP-001	RS232 9-Way to 3-Way Plug-in Connector (Upload/Download Lead)
UP-006	USB Upload/Download Lead for Config Software

Main PCBs	
AX-ACB	AC Interface Board for AX Series Panel
AX-DSP2	AX-CTL Compact/Standard Display Module Assembly c/w Key-Switch
AX-DSP	AX-CTL Large/Voice Display Module Assembly
AX-DSP/T	AX-CTL Telephone Extension Display Module US Product
AX-CTL-1PCB	1-SLC Fire Alarm Control Panel Base Card PCB Kit
AX-CTL-2PCB	2-SLC Fire Alarm Control Panel Base Card PCB Kit

Axis^{AX} Parts List

Product Code	Description
Enclosures – Standard <i>(Also available in grey. Add -G to product code)</i>	
AX-02-BB	AX-CTL-1 Small Back Box
AX-02-OD	AX-CTL-1 Small Door

Enclosures – Medium (2' x 2', 2' x 3') <i>(Also available in grey. Add -G to product code)</i>	
AX-01-BB	AX-CTL-x 2' x 2' Fault Free / 2' x 3' Fault Free Back Box
AX-01-ID1	AX-CTL-x 2' x 2' Fault Free Inner Door
AX-01-OD1	AX-CTL-x 2' x 2' Fault Free Outer Door
AX-01-ID2	AX-CTL-x 2' x 3' Fault Free Inner Door
AX-01-OD2	AX-CTL-x 2' x 3' Fault Free Outer Door

Enclosures – Large (3' x 3', 3' x 5') <i>(Also available in grey. Add -G to product code)</i>	
CCM-01-BB	Command Centre – 3' x 3' Back Box
CCM-01-ID1	Command Centre – 3' x 3' Inner Door, 1 Double and 7 Single Apertures
CCM-01-ID2	Command Centre – 3' x 3' Inner Door, 2 Double and 5 Single Apertures
CCM-01-ID3	Command Centre – 3' x 3' Inner Door, 9 Single Apertures
CCM-01-OD	Command Centre – 3' x 3' Outer Door
CCM-02-BB	Command Centre – 3' x 5' Back Box
CCM-02-ID1	Command Centre – 3' x 5' Inner Door, 1 Double and 13 Single Apertures
CCM-02-ID2	Command Centre – 3' x 5' Inner Door, 2 Double and 11 Single Apertures
CCM-02-ID3	Command Centre – 3' x 5' Inner Door 15xS
CCM-02-ID4	Command Centre – 3' x 5' Inner Door, 2 Double and 1 Single Aperture (Double Apertures on Row 1 and 3)
CCM-02-OD	Command Centre – 3' x 5' Outer Door
CCM-MP-BP2	2 x Riser/Standard PBUS Card Mounting Plate
AX-HPIN	Hinge Pin AX Panels (Pack of 6) (US Product) (Kit of Parts)

Enclosures – Other Parts	
AX-SAP*	Single Aperture Blanking Plate
AX-SAP6*	Single Aperture Blanking Plate (Pack of 6)
AX-DAP*	Double Aperture Blanking Plate
AX-DAP6*	Double Aperture Blanking Plate (Pack of 6)
AX-1C-BP*	AX-CTL-1C Battery Cover Plate – Red
AX-BAT*	External Battery Enclosure
AX-KEYL	Spare AX Panel Door Keylock 2 x CAT30 Keys
AX-KSW	2 Position 90° Key-Switch - CAT30 (C&K)
AX-ANN-TP	Tamper Proof Enclosure for Annunciator, Surface Mount Lockable
AX-ANN-WP	Tamper Proof Enclosure for Annunciator Surface Mount Lockable c/w 24VDC Heater
AXM-006	Spare Annunciator Back Box
AXM-007	Spare Annunciator Cover
AXM-008*	Spare Annunciator Bezel – Semi Flush – Red
AXM-009*	AX Peripheral Card Enclosure
AXM-010/RD*	Spare AX-CTL1 Wall Aperture Frame – Red
AXM-011/RD*	Spare AX-CTL2/4 Wall Aperture Frame – Red
AXM-012*	Mounting Plate Kit for Penn & IO48 PCBs – Red

**Also available in grey. Add -G to product code. Change /RD to /GY.*

Product Code	Description
Enclosures – Local Zone Annunciators	
AX-LZA-CAB1/RD	1-Way Local Zone Annunciator Cabinet – Red
AX-LZA-CAB2/RD	2-Way Local Zone Annunciator Cabinet – Red
AX-LZA-CAB4/RD	4-Way Local Zone Annunciator Cabinet – Red
AX-LZA-CAB1-TR/RD	Trim Ring – 1-Way Local Zone Annunciator Cabinet – Red
AX-LZA-CAB2-TR/RD	Trim Ring – 2-Way Local Zone Annunciator Cabinet – Red
AX-LZA-CAB4-TR/RD	Trim Ring – 4-Way Local Zone Annunciator Cabinet – Red

Microphone Components	
AV-MIC*	Microphone Assembly
AV-RMIC*	Remote Microphone Panel
AV-RMI	Remote Microphone Panel Interface
AV-MIC-REM*	Remote Microphone Cabinet
AV-RM-PCB	Spare AV-MIC-REM PCB

**Also available in grey. Add -G to product code.*

Fire Fighter Emergency Phone System 2 with Ring	
AV-TEL2-REM*	Telephone Riser Panel (Red) incl Riser and AX-PSU6
AV-TEL2-RISE	Telephone Riser Interface Card with Ring and Hold Tones
AV-TEL2-PPB	Plug-in Audio Module for AV-TEL2-RISE for Remote Phone Paging
AV-TEL2-MCCS	Multi-Command Center Fire Fighter Phone, Supervision Module and Enclosure for Interface to AV-TEL2-RISE Module
AV-TEL2-MCCS-P	Multi-Command Center Telephone Assembly – PTT Red Used on AX-CC Panels
AV-TEL2-CAB	Remote Cabinet Supports up to 2 AV-TEL2-RISE Modules and AX-PSU-6

**Also available in grey. Add -G to product code.*

Fire Fighter Emergency Phone System Accessories	
AV-SC-5	Fire Fighter Phone Cabinet Holds 5 Phones
AV-SC-10	Fire Fighter Phone Cabinet Holds 10 Phones
AV-TEL2-P	Portable Firefighter Handset, Coiled Cord, 1/4" Plug – Red
AV-TEL2-PT	Portable Firefighter Handset, PTT, Coiled Cord, 1/4" Plug – Red
AV-CJACK	Conventional Firefighter Phone Jack with Active LED
AV-TEL2-MWPB	Primary Firefighter Phone Interface PCB with Ring and Hold Tones
AV-TEL2-SWPB	Secondary Firefighter Phone Interface PCB with Ring and Hold Tones

Product Code	Description
Fully Assembled Fire Fighter Telephones <i>(Also available in grey. Add -G to product code)</i>	
AV-TEL2-WD	Master, Breakglass and Keylock, Standard Cord
AV-TEL2-WDV	Master, Breakglass and Keylock, Armored Cord
AV-TEL2-WDP	Master, Push-to-Talk, Breakglass and Lock, Standard Cord
AV-TEL2-WDT	Master, Push-to-Talk, Breakglass and Lock, Armored Cord
AV-TEL2-SWD	Secondary, Breakglass and Keylock, Standard Cord
AV-TEL2-SWDV	Secondary, Breakglass and Keylock, Armored Cord
AV-TEL2-SWDP	Secondary, Push-to-Talk, Breakglass and Lock, Standard Cord
AV-TEL2-SWDT	Secondary, Push-to-Talk, Breakglass and Lock, Armored Cord
AV-TEL2-WD2	Master, Keylock, Standard Cord
AV-TEL2-WD2V	Master, Keylock, Armored Cord
AV-TEL2-WD2P	Master, Push-to-Talk, Lock, Standard Cord
AV-TEL2-WD2T	Master, Push-to-Talk, Lock, Armored Cord
AV-TEL2-SWD2	Secondary, Keylock, Standard Cord
AV-TEL2-SWD2V	Secondary, Keylock, Armored Cord
AV-TEL2-SWD2P	Secondary, Push-to-Talk, Lock, Standard Cord
AV-TEL2-SWD2T	Secondary, Push-to-Talk, Lock, Armored Cord
AV-TEL2-WD3	Master, Magnet Latch with Handle, Standard Cord
AV-TEL2-WD3V	Master, Magnet Latch with Handle, Armored Cord
AV-TEL2-WD3P	Master, Push-to-Talk, Magnet Latch with Handle, Standard Cord
AV-TEL2-WD3T	Master, Push-to-Talk, Magnet Latch with Handle, Armored Cord
AV-TEL2-SWD3	Secondary, Magnet Latch with Handle, Standard Cord
AV-TEL2-SWD3V	Secondary, Magnet Latch with Handle, Armored Cord
AV-TEL2-SWD3P	Secondary, Push-to-Talk, Magnet Latch with Handle, Standard Cord
AV-TEL2-SWD3T	Secondary, Push-to-Talk, Magnet Latch with Handle, Armored Cord

Modular Phone Chassis <i>(Also available in grey. Add -G to product code)</i>	
AV-TEL2-CP1	Master Handset/Chassis Plate Assembly – Red, Coiled Cord
AV-TEL2-CP2	Master Handset/Chassis Plate Assembly – Red, PTT, Coiled Cord
AV-TEL2-CP3	Master Handset/Chassis Plate Assembly – Red, Armored Cable
AV-TEL2-CP4	Master Handset/Chassis Plate Assembly – Red, PTT, Armored Cable
AV-TEL2-CS1	Secondary Handset/Chassis Plate Assembly – Red, Coiled Cord
AV-TEL2-CS2	Secondary Handset/Chassis Plate Assembly – Red, PTT, Coiled Cord
AV-TEL2-CS3	Secondary Handset/Chassis Plate Assembly – Red, Armored Cable
AV-TEL2-CS4	Secondary Handset/Chassis Plate Assembly – Red, PTT, Armored Cable

Modular Phone Enclosures	
AV-TEL2-BB*	Back-Box Enclosure – Red, Use with Keylock Door AV-TEL2-D1
AV-TEL2-BBM*	Back-Box Enclosure – Red with Magnets, Use with AV-TEL2-D2
AV-TEL2-D1*	Keylock Door Assembly – Red with Mounting Hardware. Use with AV-TEL2-BB
AV-TEL2-D2*	Magnetic Latch Door Assembly – Red, with Door Handle, Magnets, Mounting Hardware. Use with AV-TEL2-BBM
AV-TEL2-BG	Breakglass Assembly with Screws. Use with AV-TEL2-BB and AV-TEL2-D1
AV-TEL2-LP*	Lock Plate – Red with Screws. Use with AV-TEL2-BB and AV-TEL2-D1
AV-TEL2-MB*	Semi-Flush Trim Ring – Red, Mounts to all Back Boxes
AV-TEL2-MWP-BX	Plastic Enclosure and Chassis Plate, Use to Mount 1 x AV-TEL2-MWPB

**Also available in grey. Add -G to product code.*

Product Code	Description
Detectors & Bases	
SA5800-450ADV	AX Heat Detector
SA5150-650ADV	AX Smoke Detector
SA5150-750ADV	AX Multi-Criteria (Smoke/Heat) Detector
SA5050-250ADV	XP95A Smoke Detector
SA5000-210ADV	AX Base 4"
SA5000-230ADV	AX Base 6"
SA5300-802ADV	AX High Frequency Sounder Base 6"

Duct Detection	
AX-STN-1.0	AX 10" Sampling Tube
AX-STN-2.5	AX 30" Sampling Tube
AX-STN-5.0	AX 5' Sampling Tube
AX-STN-10.0	AX 10' Sampling Tube

Pull Stations	
AX-APS2-F1	Pull Station – Red, Single Action Fire Alarm
AX-APS2-F2	Pull Station – Red, Dual Action Fire Alarm
AX-APS-BB1	Pull Station Back Box – Red, Indoor
AX-APS-BB1-D	Pull Station Back Box – Red, Deep Interior
AX-APS-BB2	Pull Station Back Box – Red, Weatherproof NEMA-3R
AX-APS-BB2-D	Pull Station Back Box – Red, Deep Weatherproof Die-cast
AX-APS-KEY	Pull Station lockset c/w 1 Key

Sounders & Beacons	
58000-011AEL	AX Open Area Sounder Beacon (Red Lens)
58000-012AEL	AX Open Area Sounder Beacon (White Lens)
55000-041AEL	Open-Area Sounder – Red
55000-042AEL	Open Area Sounder – White
55000-877AEL	Loop Powered Beacon – Red
55000-878AEL	Loop Powered Beacon – Clear (Red LED)
55000-879AEL	Loop Powered Beacon – Amber

Sounder Beacon Bases	
45681-526AEL	XP95A Sounder Beacon Base (Red LED)
45681-525AEL	XP95A Sounder Beacon Base (Yellow LED)
45681-524AEL	Discovery UL Sounder Beacon Base (Red LED)
45681-527AEL	Discovery UL Sounder Beacon Base (Yellow LED)
45681-292AEL	White Base Cap
45681-293AEL	Red Base Cap

Modules	
55000-750AEL	Isolator Module
55000-765AEL	Mini Monitor Module (Din Rail Mount)
55000-805AEL	Switch Monitor Module
55000-831AEL	Mini Switch Monitor Module
55000-806AEL	Priority Switch Monitor Module
55000-830AEL	Mini Priority Switch Monitor Module
55000-790AEL	Dual Priority Switch Monitor Module
55000-820AEL	Switch Monitor Input / Output Module
55000-825AEL	Sounder Control Module
55000-863AEL	Relay Output Module



Email: enquiries@advancedco.com
Web: www.advancedco.com

 @advancedlive

 Advanced

 Advanced Fire

 **NBS Source**
PARTNER

Find us on NBS National BIM Library
www.nationalbimlibrary.com/advanced-electronics-ltd

Axis AX and all other Advanced product brands are trademarks of Advanced Electronics Ltd. All rights reserved.



A **Halma** company